

The Rwandan Orphans Project

Ron Reinsch, Chairman rreinsch@san.rr.com

Tim Botsko, Coordinator tbotsko3@cox.net

In association with Christ Lutheran Church, Pacific Beach
4761 Cass Street, San Diego, CA 92109
(858) 483-2500

CELPAR - Kigali, Rwanda - contact Jotham Gasatura

Architect - Andre Verbruggen, Kigali, Rwanda

The Rwandan Orphans Project

El Shaddai Boarding School and Community Center



The current orphanage



Sponsored by
C.E.L.P.A.R.
(Communaute des
Eglises Libres de
Pentacotes Afrique au
Rwanda)

The Rwandan Orphans
Project

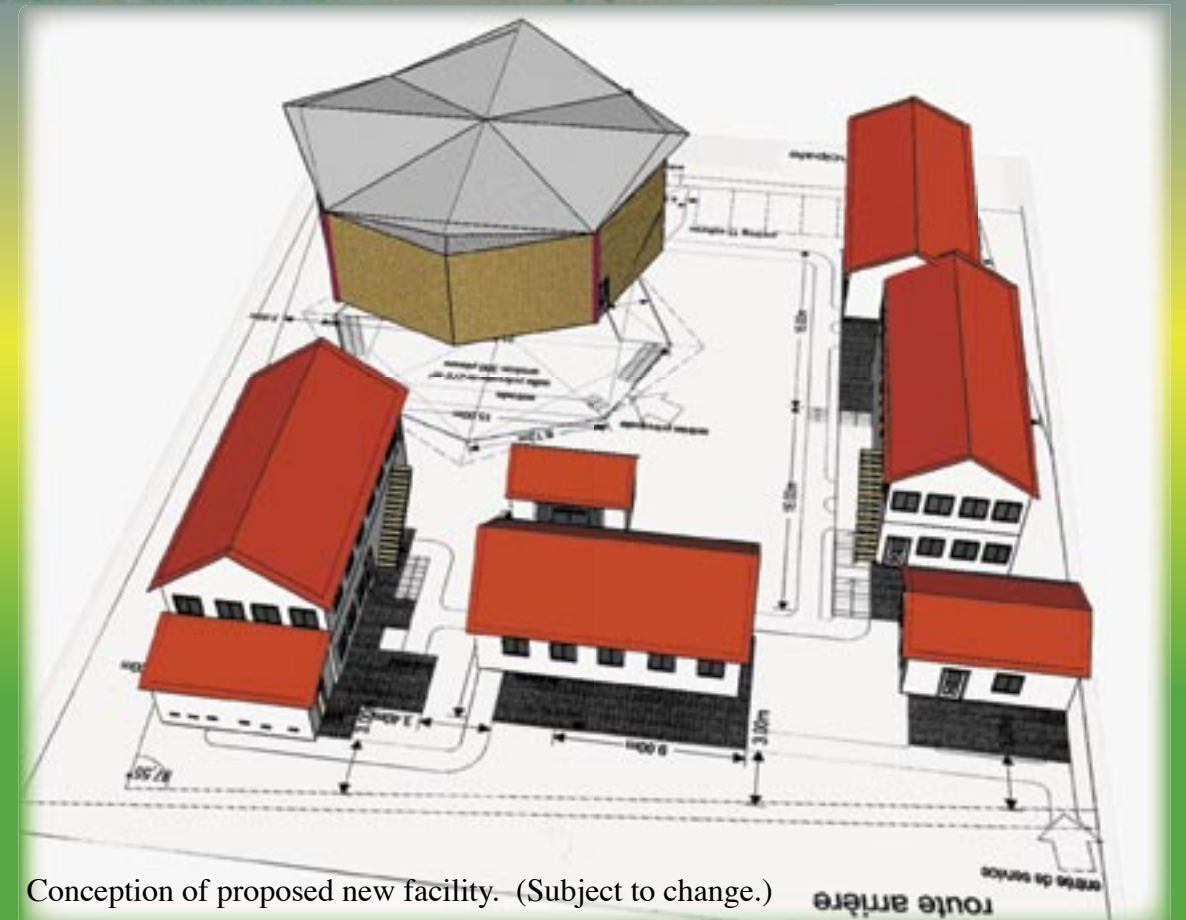

Conception of proposed new facility. (Subject to change.)

El Shaddai Orphanage, Kigali, Rwanda



El Shaddai

El Shaddai School and Orphanage is currently located in a condemned, partially abandoned warehouse on the outskirts of Kigali, Rwanda. 150 boys between the ages of 5 and 18 live there full time. Another 250 boys and girls come from all over Kigali for a daytime program that includes meals, Catch-Up School, vocational training, dance classes, medical care, and religious services. All of these children are orphans of the genocide, revenge killings, AIDS, or the inability of the surviving members of their families to care for them. The government of Kigali intends to demolish the existing building and redevelop the area where it is located, making it necessary to acquire property and build a new facility. The demolition could take place at any time.

El Shaddai is sponsored by C.E.L.P.A.R. (Communaute des Eglises Libres de Pentacotes Afrique au Rwanda). C.E.L.P.A.R. already has access to land on which the new facility can be built. It will be necessary to purchase existing structures on the site. The proposed site is more central to Kigali, close to athletic fields.

As designed, the new facility will provide the same square meterage of dormitory, classroom, infirmary, refectory, sanitary, office, food-storage and preparation, and public assembly/worship space as exists at the current location. The new facility would obviously be a great improvement over the current situation. Construction will be done in traditional Rwandan fashion -- concrete slabs with brick or concrete block walls finished with plaster, with corrugated metal roofs. The roof of the Assembly Building is designed to channel rain water into a collection system that feeds into a large charcoal filter to provide potable water.

It is also possible to add commercial stalls -- either to be operated as stores to sell crafts and food produced by the street kids or to be rented to others. -- along the road behind the plot. Every aspect of the design has been carefully considered to maximize the utility of the project while cost-effectively providing a pleasant, secure home for children who have huge potential, and no other chance for a worthwhile future.

The Rwandan Orphans Project needs your financial help.

Architect's conception of new facilities
Communal Building



Classrooms

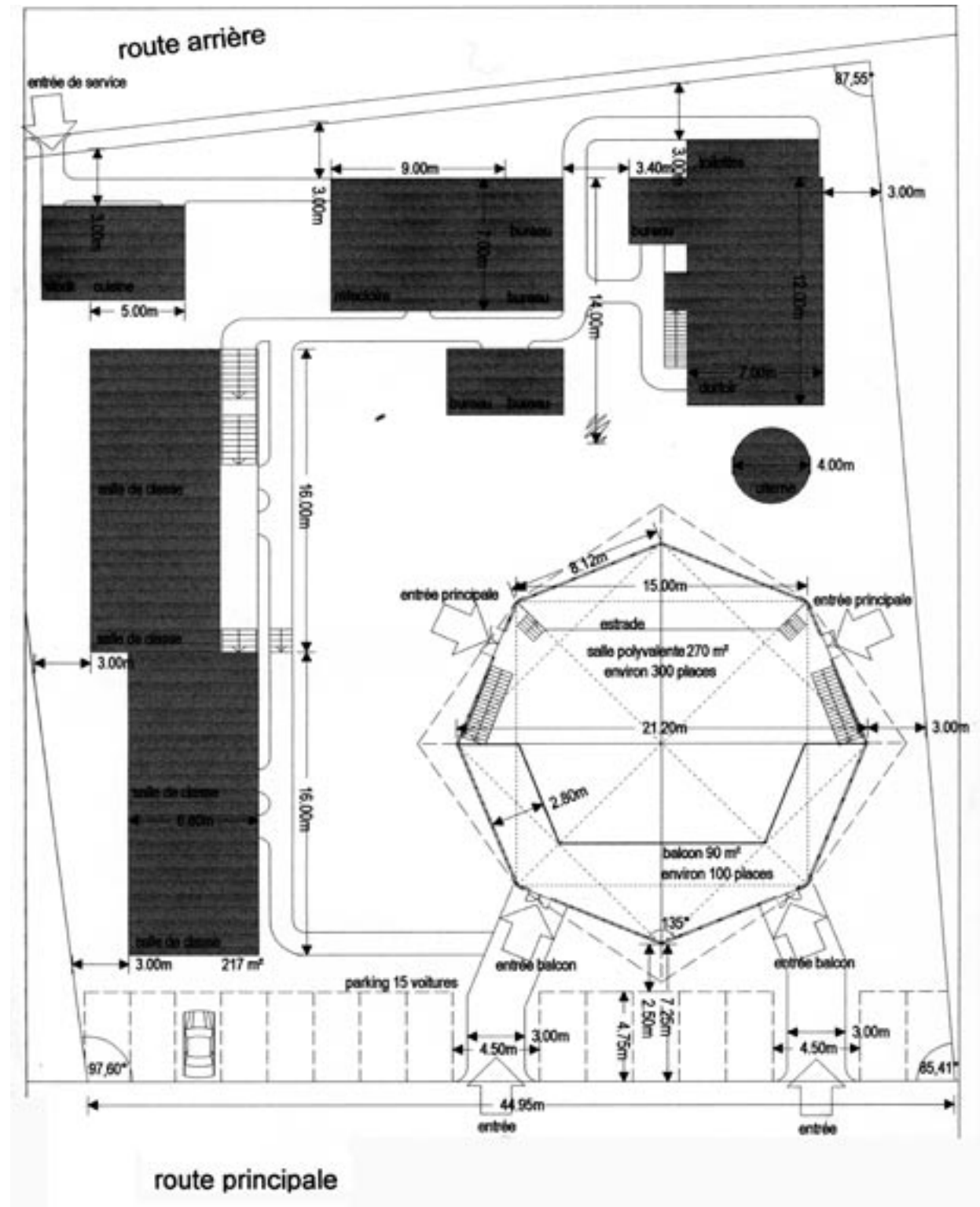

Estimated cost of construction:
\$750,000 USD